

BAXI

Innovative Heating & Cooling Systems



Domestic Range

General Catalogue

November 2018

Company Profile

BAXI S.p.A. has a proud tradition of developing and producing boilers and heating systems to the highest technological standards. For 40 years BAXI S.p.A. has provided a wide range of cutting-edge solutions, anticipating market evolutions and paying attention to customer needs.

How to read this catalogue

In this catalogue we show the complete range of BAXI products. On each page, in addition to the product benefits, there is a detailed list of the appliance characteristics, a technical chart, and coloured icons. These icons refer to the specific pages of the catalogue where, by segment, the technical drawings and all the specific accessories are represented.

In the technical sections you will find:

		
Technical section	Flue pipe accessories	Hydraulic accessories
		
Thermoregulation accessories	Outdoor accessories	Other accessories

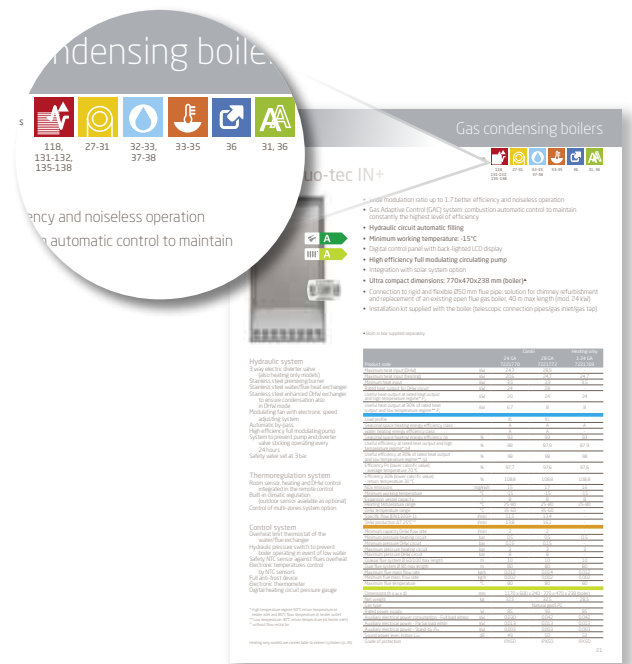

Index

Digital	4
Gas condensing boilers	11
Gas boilers	37
Non-ErP gas boilers	39
Heat pumps	59
Hybrid systems	72
Solar systems	82
Water heaters	96
Air Conditioning	107
Technical section	111

Digital

- Baxi Mago 5
- Baxi Air Connect + wi-fi module 9

Baxi Mago

The chronothermostat that simplifies your life



BAXI MAGO
think simple!



Baxi Mago is the modulating chronothermostat with integrated wi-fi, designed to simplify the life of installers and end users. It allows to control your home comfort (boiler, heat pump) via mobile application thanks to the wi-fi connection*, wherever you are.

The app can be downloaded from your smartphone or tablet and it is possible to connect one or more households to: control the heating, manage the schedule, display consumptions, display boiler fault diagnosis, set holiday mode, etc.

An innovative tool with a unique design, combining extreme ease of use and modern design.

OPENTHERM
ON/OFF



Aesthetically pleasing and easy to use!

Thanks to the knob and to the back-lighted display the temperature can be easily adjusted. The display screen is easy to read. Presence detection allows the unit to light up when you approach it. The intuitive menu has a top button to select and confirm operation and a bottom button to go back and return to Home screen.



Quick Auto Programming

Quick Auto Programming automatically creates a schedule based on your habits after answering a few questions..

* If the option is available in your country.



Multiple smartphones or tablets control option

Pairing the device allows the heating control, wherever you are. Multiple smartphones or tablets control option is available, so each member of the family can interact.



It follows your schedule!

Schedule your central heating to come on when you need it, setting two different weekly schedules. It is also possible to create five different scenarios related to multiple temperature requirements ("day", "night", "evening", "out of home", etc.).



Consumptions under control

It provides a guide to how much energy your heating system is using showing weekly, monthly or annual consumptions graphs.



It helps you saving money!





Baxi Mago allows you saving money on your energy bills: thanks to the control from smartphone or tablet, it is possible to reduce the temperature while you are away, with saving on consumptions. Furthermore, it modulates the power of the boiler with less consumptions both on heating and DHW production.

Baxi Mago



- Chronothermostat with integrated wi-fi module
- To connect Baxi Mago to the domestic internet, it is not necessary to connect other devices to the router
- Remote control APP for smartphones and tablets only
- It is possible to connect one or more households for temperature control, weekly plan management, holiday mode selection etc.
- Multiple device management: it is possible for more than one person to interact with the chronothermostat
- Quick Auto Programming automatically creates a schedule based on your habits after answering a few questions

BAXI MAGO
think simple!

Model	Code
 <p>Chronothermostat Baxi Mago with integrated wi-fi module + adapter kit GTW16 (OpenTherm and ON/OFF)</p> 	7652303
 <p>Chronothermostat Baxi Mago with integrated wi-fi module (R-BUS)</p> 	7701201

Technical drawings/graphs

BAXI MAGO

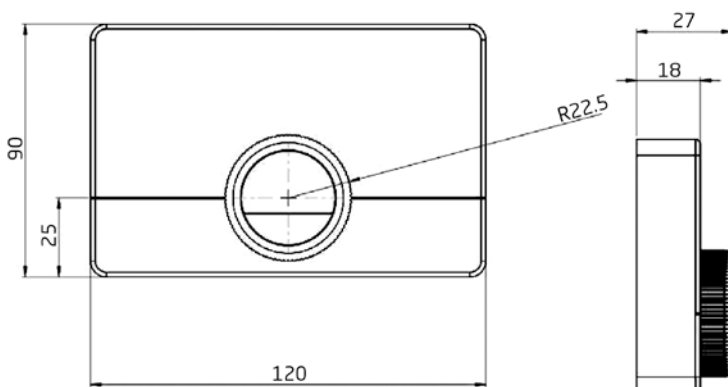

The dimensions of Baxi Mago have been designed in order to cover the electric Box 503

ADAPTER KIT (GATEWAY)

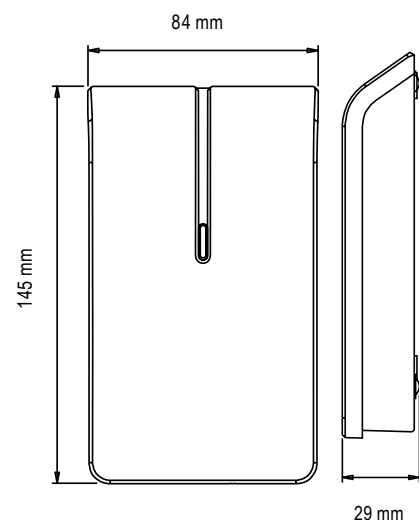

Installation schemes

Baxi Mago + GTW16 (Modulating OpenTherm or On/Off)

- 1) Adapter kit connection (OpenTherm or On/Off *)
- 2) Adapter kit (GTW16) with 24V transformer
- 3) Baxi Mago connection (R-Bus; 2 wires, possibly shielded cables)
- 4) Domestic wi-fi connection to the Router
- 5) Connection with App Baxi Mago

* to locate OpenTherm terminal in the boiler, see boiler technical guide

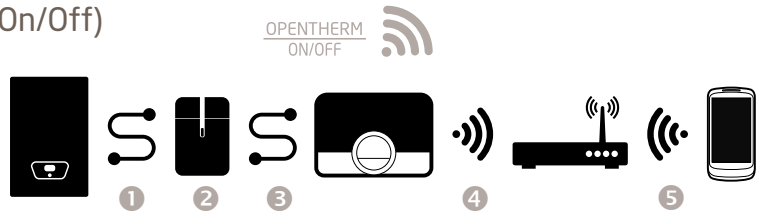

Baxi Mago

- 1) Baxi Mago connection (R-Bus; 2 wires, possibly shielded cables)
- 2) Domestic wi-fi connection to the Router
- 3) Connection with App Baxi Mago

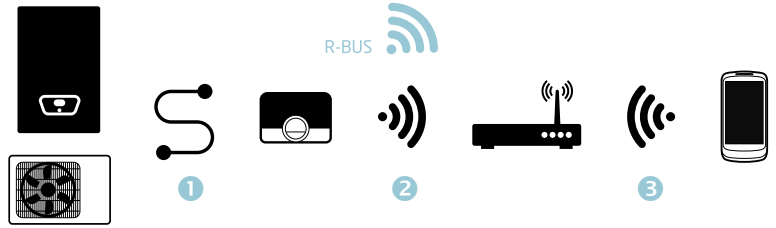

Packages

Baxi Mago + GTW16 for products with OpenTherm protocol

1) Baxi Mago package:

- Baxi Mago
- Screw and plug fixings
- Mounting bracket for wall hung installation
- User guide

2) Gateway package:

- Adapter kit or Gateway (GTW)
- Power adapter, exposed wires to be connected inside the boiler
- Screw and plug fixings
- Installation guide

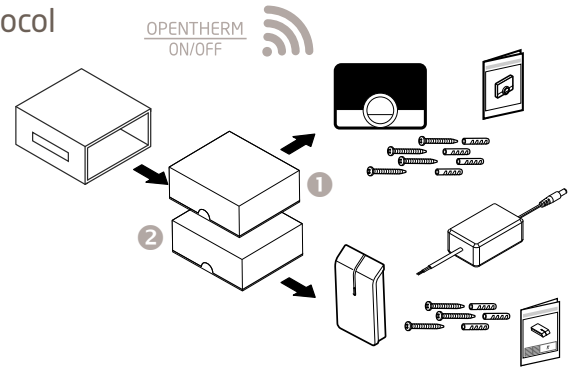

Baxi Mago for products with R-BUS protocol

1) Baxi Mago package:

- Baxi Mago
- Screw and plug fixings
- Mounting bracket for wall hung installation
- User guide

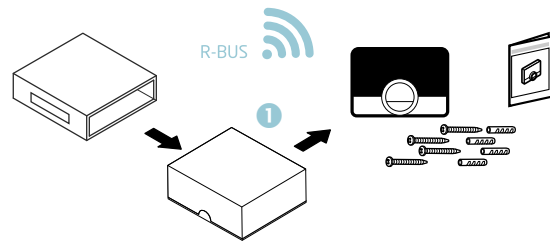

Technical data

Dimensions	
Width x height x depth (Baxi Mago)	120 x 90 x 27 mm
Width x height x depth (Gateway) - only for Baxi Mago with OpenTherm or ON/OFF protocol	84 x 145 x 29 mm
Electrical power supply	
Bus connection voltage	24 V ± 5%
Maximum electrical consumption	1,5 W
Electrical connection	
Maximum cable length for dedicated Baxi Mago bus	50 m
Maximum cable resistance	2 x 5 ohm
Ambient conditions	
Operating conditions	from 0 °C to 60 °C
Temperature	
Measurable room temperature range	from 5 °C to 60 °C
Maximum temperature deviation at 20°C	0,3 °C
Maximum room control overshoot after pre-heating	1 °C
Temperature variation	+/- 0,5 °C
Temperature control range	from 10 °C to 30 °C

Baxi Air Connect: Smart Comfort



The Air Connect App and the wi-fi module allow the remote control of Baxi Luna Clima air conditioners.

Air Connect is the application to have the full control of the temperature and the comfort of the house or of the office at any moment and from everywhere.

Once the wi-fi module is installed (see the installation manual for instruction) and Air Connect is downloaded, it is possible to control the air conditioners from smartphones and tablet (iOs and Android system).

It is possible to:
 turn on/off the air conditioner, choose the operating mode, set the fan speed, set the flip horizontal and vertical swing (where it is possible), display all active functions, set a timer, etc.



Baxi Air Connect + wi-fi module



Air Connect means easy and intuitive comfort control:

- Direct and easy connection to Baxi air conditioner via smartphone and tablet.
- No visual impact: the wi-fi module is installed in the dedicated location behind the frontal panel of the air conditioner (wall hung models) or inside the air conditioner (Light Commercial models).
- Easy scheduling of the timetable that combines comfort and significant energy savings.
- More indoor units can be controlled with the same application (Multi split models), as long as a wi-fi module is installed in each unit.
- Same functions as the remote control directly from your device, for example: Turbo, Sleep, iClean, etc.



Model	Code
Air Connect wi-fi per Luna Clima	7660110

Technical data

Wi-fi module dimensions (to install behind the frontal panel)	
Dimensions (wxhxd) mm	57,8x36,4x8,0
Electrical power supply	
Connection voltage	12 V + 2,5%
Ambient conditions	
Operating conditions	From -10 °C to 80 °C
Operating frequency	
Functioning frequency	2.412~2.472 GHz
Others	
Protocol	IPv4, TCP/UDP/FTP/http/HTTPS/TLS/mDNS
Safety	WEP/WPA/WPA2
Type of network	STA/AP/STA+AP/WIFI Direct

Wi-fi module package contents

The packaging includes: wi-fi module, Light Commercial connection cable, start guide and warranty certificate.

Terms of service

The application can be used with more Baxi indoor units, as long as a wi-fi module is installed in every unit.

Gas condensing boilers

Heating only and combi	
- Luna Platinum+	12
- Luna Duo-tec+	13
- Duo-tec Compact+	14
- Duo-tec Compact - non Erp	15
- Prime	16
Combi with DHW storage	
- Nuvola Platinum+	17
- Nuvola Duo-tec+	18
Heating only and Combi for outdoor installation	
- Luna Duo-tec IN+	19
- Luna Duo-tec IN+ version Luna Space	20
Combi with DHW storage and solar integration	
- Power 32	21
ErP combination boilers	
- Luna Duo-tec+ 1.28 GA B80	22
- Luna Duo-tec+ 1.28 GA/UB80	22
- Luna Duo-tec+ 1.28 GA/B120	23
- Duo-tec Compact+ 28 GA/UB 200 Solar	23
Indirect cylinders connectable to heating only boilers	
- UB 120/160 SC	24



112,
129-130,
133-136



25-29



30-31,
35-36



31-33



29, 34

Luna Platinum+



ErP
OK



- Wide modulation ratio up to 1:10 (1:6 mod. 1.12 GA) better efficiency and noiseless operation
- Gas Adaptive Control (GAC) system: combustion automatic control to maintain constantly the highest level of efficiency
- Removable control panel for wall-hung installation with wide text display, regulation knob, menu selection buttons and back-lighting; supplied with the boiler
- Built-in solar control ▲
- High efficiency full modulating pump
- Complete soundproofing of the generator
- Frontal access for advanced diagnostics
- Ø50 mm flue pipe mod. 24 kW, 40 m max length

Hydraulic system

3 way electric diverter valve (also heating only models)
Stainless steel premixing burner
Stainless steel water/flue heat exchanger
Stainless steel enhanced DHW exchanger to ensure condensation also in DHW mode (combi models)
Modulating fan with electronic speed adjusting system
Automatic by-pass
High efficiency full modulating pump of the heating circuit with built-in air vent
System to prevent pump and diverter valve sticking operating every 24 hours
Heating circuit relief valve set at 3 bar

Thermoregulation system

Built-in climatic regulation (outdoor sensor available as optional)
Control of multi-zones system option
Cascade installation option
Room sensor, heating circuit and sanitary timers included in the control panel

Control system

Overheat limit thermostat of the water/flue exchanger
Hydraulic pressure switch to prevent boiler operating in event of low water
Safety NTC sensor against flues overheat
Electronic temperatures control by NTC sensors
Full anti-frost device
Electronic thermometer
Digital heating circuit pressure gauge

▲ in case of contemporary control of a solar system and a zone by the wall-mounted control panel, it is necessary to install a programmable clip in/external module THINK.

* High temperature regime: 60°C return temperature at heater inlet and 80°C flow temperature at heater outlet

** Low temperature: 30°C return temperature (at heater inlet)

⁽¹⁾ without flow restrictor

Product code	Combi			Heating only		
	24 GA 7219692	33 GA 7219693	1.12 GA 7219668	1.18 GA 7219689	1.24 GA 7219690	1.32 GA 7219691
Maximum heat input (DHW)	kW	24,7	34	-	-	-
Maximum heat input (heating)	kW	16,5	24,7	12,4	17,4	24,7
Minimum heat input	kW	2,5	3,4	2,1	2,1	2,5
Rated heat output for DHW circuit	kW	24	33	-	-	-
Useful heat output at rated heat output and high temperature regime* P_4	kW	16	24	12	16,9	24
Useful heat output at 30% of rated heat output and low temperature regime** P_3	kW	5,4	8	4	5,7	8
Load profile		XL	XXL	-	-	-
Seasonal space heating energy efficiency class		A	A	A	A	A
Water heating energy efficiency class		A	A	-	-	-
Seasonal space heating energy efficiency η_s	%	93	93	93	93	93
Useful efficiency at rated heat output and high temperature regime* η_4	%	88,0	87,9	88,0	87,9	87,9
Useful efficiency at 30% of rated heat output and low temperature regime** η_1	%	98,1	98,1	98,2	98,1	98
Efficiency P_h (lower calorific value) - average temperature 70 °C	%	97,7	97,6	97,7	97,6	97,6
Efficiency 30% (lower calorific value) - return temperature 30 °C	%	108,9	108,9	109	108,9	108,9
NOx emissions	mg/kWh	18	26	23	27	28
Minimum working temperature	°C	-5	-5	-5	-5	-5
Expansion vessel capacity	l	8	10	8	8	10
Heating temperature range	°C	25-80	25-80	25-80	25-80	25-80
DHW temperature range	°C	35-60	35-60	-	-	-
Specific flow (EN 13203-1)	l/min	11,5	15,8	-	-	-
DHW production ΔT 25°C ⁽¹⁾	l/min	13,8	18,9	-	-	-
Minimum capacity DHW flow rate	l/min	2	2	-	-	-
Minimum pressure heating circuit	bar	0,5	0,5	0,5	0,5	0,5
Minimum pressure DHW circuit	bar	0,15	0,15	-	-	-
Maximum pressure heating circuit	bar	3	3	3	3	3
Maximum pressure DHW circuit	bar	8	8	-	-	-
Coaxial flue system Ø 60/100 max length	m	10	10	10	10	10
Dual flue system Ø 80 max length	m	80	80	80	80	80
Maximum flue mass flow rate	kg/s	0,011	0,016	0,006	0,008	0,011
Minimum flue mass flow rate	kg/s	0,001	0,002	0,001	0,001	0,001
Maximum flue temperature	°C	80	80	80	80	80
Dimensions (h x w x d)	mm	763 x 450 x 345				
Net weight	kg	38,5	39,5	34,5	34,5	37,5
Gas type		Natural gas/LPG				
Rated power supply	W	91	105	64	83	91
Auxiliary electrical power consumption - Full load e_{max}	kW	0,025	0,035	0,025	0,040	0,050
Auxiliary electrical power - Partial load e_{min}	kW	0,012	0,012	0,012	0,012	0,012
Auxiliary electrical power - Stand-by P_{SB}	kW	0,004	0,004	0,004	0,004	0,004
Sound power level, indoor L_{WA}	dB	50	53	50	57	57
Grade of protection		IPX5D	IPX5D	IPX5D	IPX5D	IPX5D

Heating only models are connectable to indirect cylinders (p. 24)



Quality Environment Safety

are Baxi strategic aims and the awarded certifications ensure compliance with the specific regulations

BAXISPA

36061 BASSANO DEL GRAPPA (VI)
Via Trozzetti, 20
marketing@baxi.it
www.baxi.it

The Company assumes no responsibility for any possible contents mistakes, and reserves the right to make changes in products, due to technical or commercial demands, at any time without notice.

Baxi S.p.A. 11-18 (E)

